

Refilling Instructions

for **Epson S020036 Color Ink Cartridge**
used in **Epson Stylus Color Printers**

1. Remove color ink cartridge from printer and protect work surface.

Refilling your cartridge is a clean and simple job, but it is best to cover your work area with newspaper or other scrap paper to protect from accidental ink spills.

2. Place label on top of the cartridge.

Holding the cartridge with large silver label facing you, place the clear sticker with the colored dots on the top of the cartridge along the edge closest to you. The dots should be placed from left to right magenta first, then cyan, and yellow. See fig. 2, 3, & 4.

3. Cover ink port holes with stickers.

Before placing the stickers over the port holes, make sure that each of these port holes is wiped dry so as to ensure an adequate seal. With the cartridge in the same position, use three of the small round yellow stickers provided to seal each of the ink port holes as shown in Fig. 1.

4. Drill three fill holes in top of cartridge.

Hold the cartridge so that the large silver label and the vent holes facing you, as shown in Fig. 2. Using the drilling tool provided, and using a twisting motion, drill three holes, one in the center of each of the three colored chambers. (See Fig. 3) The drill holes should be placed approximately 1/4" straight out from the tip of each colored dot. (See Fig. 4.) (This effectively will place a single hole in the center of each chamber.) Withdraw drill bit after drilling each hole.

5. Fill the ink chambers with the corresponding colors of ink.

Remove the scabbard from the tip of the filling needle. Tilt the ink bottle slowly until it is in the horizontal position. While keeping the bottle horizontal, place the needle tip into the refill hole (see Fig. 5) then invert the bottle. Once the bottle is upside down, lower the needle into the ink chamber as far down as it will go. (See Fig. 6.) Begin gently applying pressure to the bottle, squeezing as the needle is slowly withdrawn. Continue dispensing ink until 15 ml has been emptied, or until a droplet of ink appears at the vent hole or fill hole, (See Fig. 2) as these are indications that the cartridge is full.

6. Remove the refill bottle.

If the refill bottle is not empty, recap it and save for future use. Blot up any residual ink around the vent holes or fill holes with a tissue. You can top off all the colors even if they are not empty. Use the same procedure and stop filling when you see an ink droplet at the vent hole or fill hole.

7. Place stickers over drill holes.

Make sure that the area around the drill holes is wiped dry so as to ensure an adequate seal. Use three of the stickers provided to cover the drill holes on top of the cartridge. **You can either leave the stickers you previously placed over the ink port holes in place or remove them.** If the stickers are left in place, the printer will puncture holes in them when the cartridge is reinstalled.

8. Reinstall the cartridge into the printer.

Perform the printhead cleaning procedure following the instructions outlined in your printer instruction booklet.

In the unlikely event that ink gets on your fingers, it can easily be removed by moistening a paper towel with a solution of laundry bleach diluted with an equal amount of water. Be sure to wash hands thoroughly after using bleach solution.

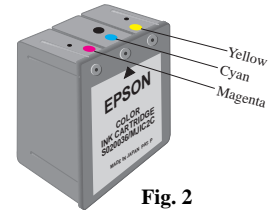
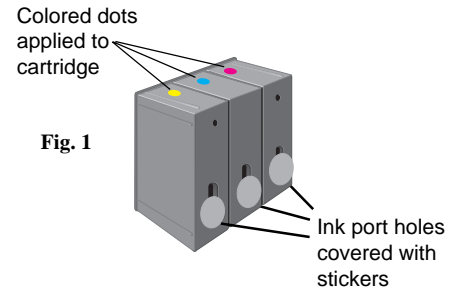

Fig. 2

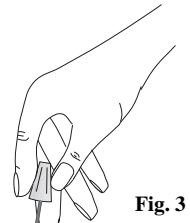

Fig. 3

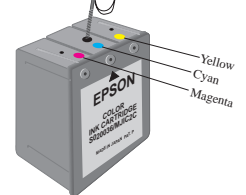

Fig. 4

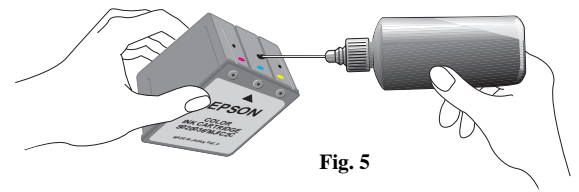
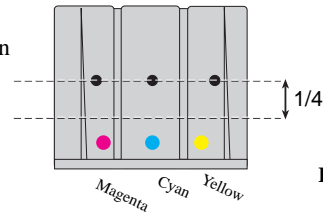

Fig. 5

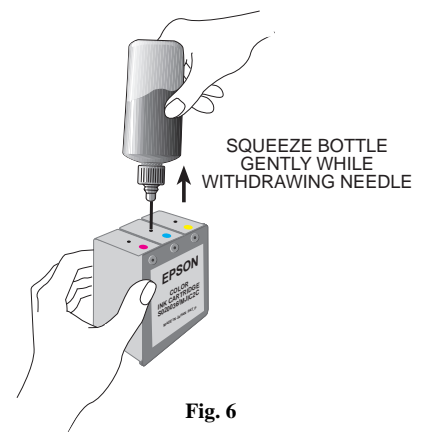

Fig. 6

IF YOU HAVE ANY QUESTIONS OR ENCOUNTER ANY DIFFICULTY IN USING THIS PRODUCT, PLEASE CONTACT:

REPEAT-O-TYPE
MANUFACTURING CORPORATION
ESTABLISHED 1931

665 State Highway 23 • Wayne, NJ 07470-6892
(973) 696-3330 • (800) 288-3330 • Fax (973) 694-7287