

Refilling Instructions

for **Epson S020034 Black Ink Cartridge**
used in **Epson Stylus Color Printers**

1. Remove ink cartridge from printer and protect work surface.

Refilling your cartridge is a clean and simple job, but it is best to cover your work area with newspaper or other scrap paper to protect from accidental ink spills.

2. Cover ink port hole with sticker.

Before placing the sticker over the hole, make sure that the port hole is wiped dry so as to ensure an adequate seal. Holding the cartridge with the ink port hole facing you, apply one of the small round yellow stickers provided to cover the ink port hole as shown in Fig. 1.

3. Drill fill hole in top of cartridge.

Turn the cartridge around, so that you are now holding it with the large silver label and the vent hole facing you, as shown in Fig. 2. Using the drilling tool provided, and using a twisting motion, drill a hole in the center of the top of the cartridge. (See Fig. 3.) Withdraw drill bit after drilling the hole.

4. Fill the ink chamber.

Remove the scabbard from the tip of the filling needle. Tilt the ink bottle slowly until it is in the horizontal position. While keeping the bottle horizontal, place the needle tip in the refill hole (see Fig. 4) then invert the bottle. Once the bottle is upside down, lower the needle into the ink chamber as far down as it will go. Begin gently applying pressure to the bottle, squeezing as the needle is slowly withdrawn. (See Fig. 5.) Continue dispensing ink until 20 ml has been emptied, or until a droplet of ink appears at the vent hole or fill hole, (See Fig. 2) as these are indications that the cartridge is full.

5. Remove the refill bottle.

If the refill bottle is not empty, recap it and save for future use. Blot up any residual ink around the vent hole or fill hole with a tissue.

6. Place sticker over drill hole.

Make sure that the area around the drill hole is wiped dry so as to ensure an adequate seal. Use one of the stickers provided to cover the new drill hole on top of the cartridge. **You can either leave the sticker you previously placed over the ink port hole in place or remove it.** If the sticker is left in place, the printer will puncture a hole in it when the cartridge is reinstalled.

7. Reinstall the cartridge into the printer.

Perform the printhead cleaning procedure following the instructions outlined in your printer instruction booklet.

In the unlikely event that ink gets on your fingers, it can easily be removed by moistening a paper towel with a solution of laundry bleach diluted with an equal amount of water. Be sure to wash hands thoroughly after using bleach solution.

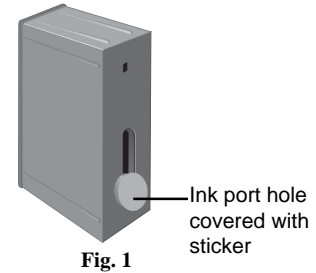

Fig. 1

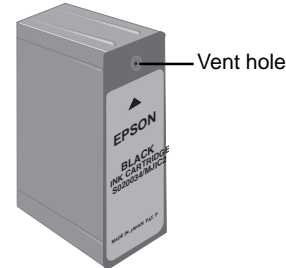

Fig. 2

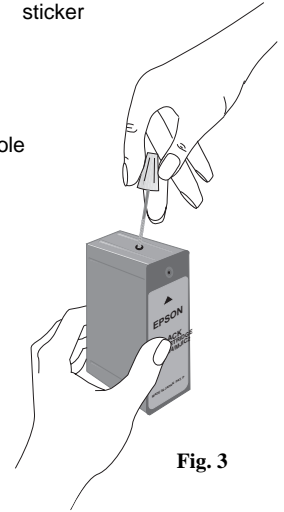

Fig. 3

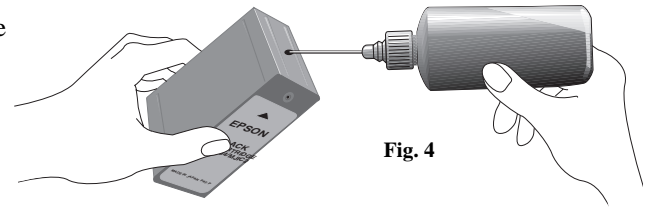

Fig. 4

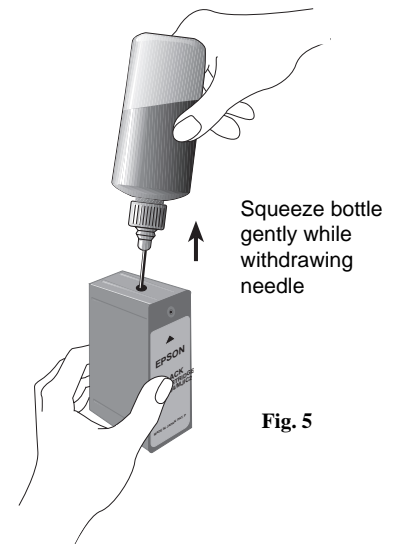

Fig. 5

IF YOU HAVE ANY QUESTIONS OR ENCOUNTER ANY DIFFICULTY IN USING THIS PRODUCT, PLEASE CONTACT:

REPEAT-O-TYPE
MANUFACTURING CORPORATION
ESTABLISHED 1931

665 State Highway 23 • Wayne, NJ 07470-6892
(973) 696-3330 • (800) 288-3330 • (973) 694-7287