

Refilling Instructions

For Epson

S020093 used in Epson Stylus Color 400/500/600/Photo/Photo 700/Photo EX

S020108 used in Epson Stylus Color 800/850/850N/850Ne/1520

S020187 used in Epson Stylus Color 440/640/Photo 750/Photo 1200

S020189 used in Epson Stylus Color 740



1. Remove black ink cartridge from printer and protect work surface. Refilling your cartridge is a clean and simple job, but it is best to cover your work area with newspaper or other scrap paper to protect from accidental ink spills.
2. Secure ink bottle while filling the syringe with ink. See Figure 1. Fill syringe with 3cc of ink, being careful not to draw air bubbles into the syringe.
3. Hold the cartridge with ink port holes facing upward. See Figure 2. Hold the syringe **TIGHTLY** against the ink port. See Figure 3. Inject the ink **VERY SLOWLY** into the chamber. See Figure 4.
4. If you are refilling the S020093 or S020187 cartridge used in the Epson Stylus Color 400/440/500/600/640/Photo/Photo700/Photo750/Photo 1200/Photo EX printers dispense two syringes full (6cc) of ink into the cartridge. If ink starts to seep from the air vent on the underside of the cartridge stop dispensing ink.
5. If you are refilling the S020108/S020189 cartridge used in the Epson stylus Color 740/800/850 and 1520 dispense 3 syringes full (9cc) of ink into the cartridge. If ink starts to seep from the air vent on the underside of the cartridge stop dispensing ink.
6. Using the wipe supplied, wipe ink from around the port hole **being sure that the area is dry**. Seal the ink port with one of the round yellow seals supplied. Press it firmly in place. See Figure 5.

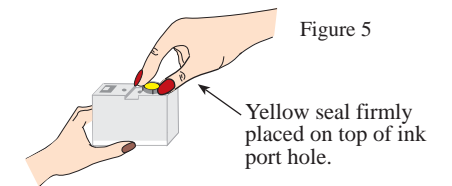
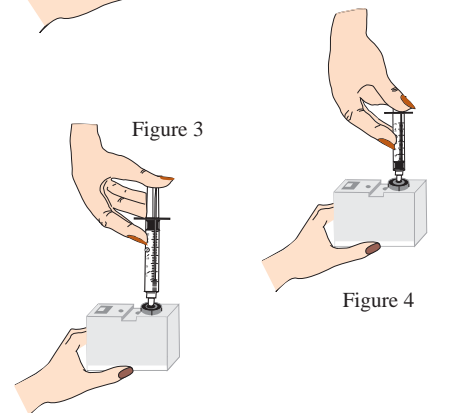
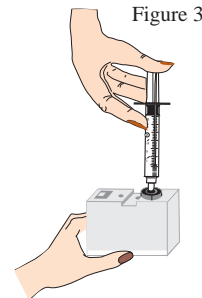
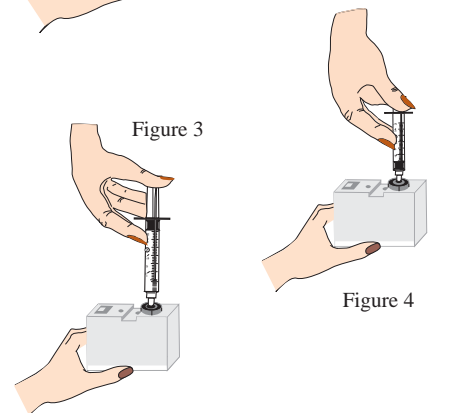
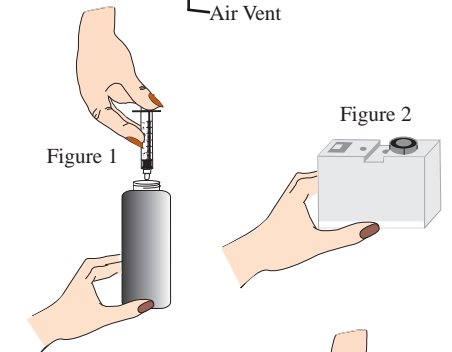
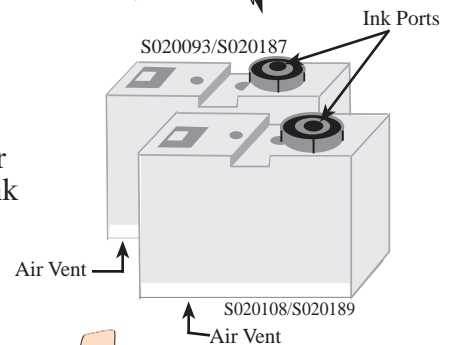

Note 1. Our inks are filtered to remove all particles larger than 1 micron. filling through the ink port will not introduce foreign particles to the printhead because the printer itself has filter screens between the ink ports and the printheads.

In the unlikely event that ink gets on your fingers, it can easily be removed by moistening a paper towel with a solution of laundry bleach diluted with an equal amount of water. Be sure to wash hands thoroughly after using bleach solution.

IF YOU HAVE ANY QUESTIONS OR ENCOUNTER ANY DIFFICULTY IN USING THIS PRODUCT, PLEASE CONTACT:

REPEAT-O-TYPE
MANUFACTURING CORPORATION
ESTABLISHED 1931

665 State Highway 23 • Wayne, NJ 07470-6892 U.S.A. • (973) 696-3330 • (800) 288-3330
Fax: (973) 694-7287 • Email: help@repeatotype.com

Epson is a trademark of Seiko Epson Corp. ©1999 Repeat-O-Type Manufacturing Corporation.