

Refilling Instructions

for CANON BJI201Cyan, BJI201Magenta and BJI201Yellow Cartridges
for APPLE M1949G/A Cyan, M1950G/A Magenta, M1951G/A Yellow

1. Cover work surface with about 10 sheets of newspaper to protect against spills.
2. Remove empty ink cartridge from printer.

⊗ FIRST TIME YOU REFILL CARTRIDGE:

3. Lay cartridge on its side so that the finger grip is at the upper right corner as you view it. (See Fig. 1)
4. If necessary, peel back the cartridge label to expose the side of the cartridge facing upward. Locate the upper left corner of the empty liquid chamber of the cartridge. (See "X" mark on Fig. 2)
5. Using the drill tool provided, drill a vent hole into the side of the cartridge. (Do not drill into the opposite wall of the cartridge.) Remove the drill by continuing to twist in a clockwise direction and pulling upward at the same time. This will help in keeping plastic debris from falling into the cartridge. Brush any plastic debris off the cartridge surface.
6. Remove the cap from the ink dispenser bottle.
7. Hold the cartridge so that the foam sponge portion is at the top and the liquid chamber is at the bottom. (See Fig. 3)
8. Touch the dispenser tip to the ink port of the cartridge so that it lightly touches the foam sponge. Do not push sponge in or it will not make proper contact with the printhead after filling. (Fig. 4)
9. Very slowly squeeze the dispenser bottle so that the ink flows through the foam sponge chamber and into the liquid chamber.
10. Continue dispensing ink until the liquid chamber is filled to just below the vent hole you previously drilled. (See Fig. 5)
11. Withdraw the dispenser bottle and place it on a flat surface.
12. Still holding the cartridge in the same position and using the absorbent pad provided, wipe around the vent hole to remove any ink that may have accidentally spilled from the vent hole. Make sure the surface around the vent hole is thoroughly dry.
13. Seal the vent hole using one of the round pressure sensitive adhesive seals provided. Press this seal very firmly in place. If you previously peeled back the original label, press back in place over the round seal.

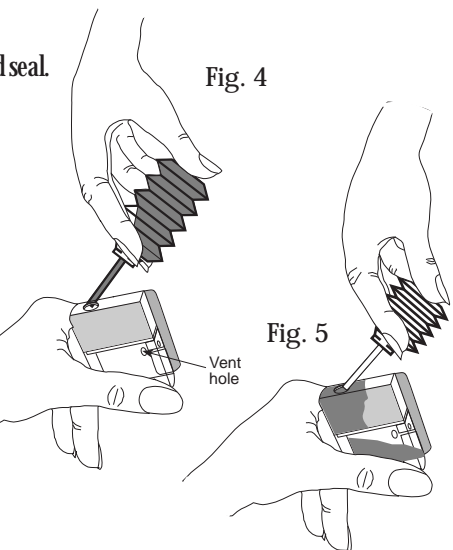
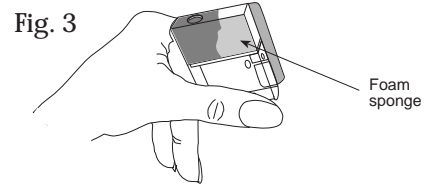
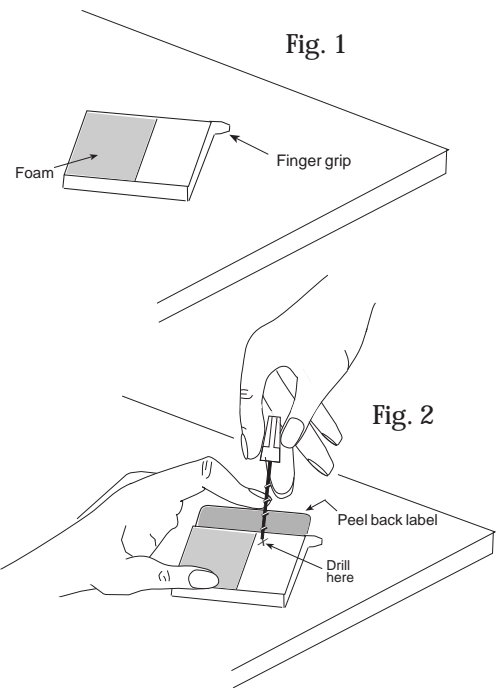

IMPORTANT! It is essential that the vent seal be air tight.* Test for a good seal by turning the cartridge so that the ink port faces down. Make sure that no ink drips from the ink port. If dripping occurs, it indicates that the vent hole is not sealed properly and a new adhesive seal must be applied. If you have already used the round seals provided any quality brand of transparent plastic tape can be used.

14. Your refilled cartridge is now ready to use. If any ink remains in the dispenser bottle recap it for future use.

* The manufacturer's warranty on this product will be void if leakage occurs due to improper sealing of the vent hole.

⊗ SUBSEQUENT REFILL PROCEDURE:

1. Peel back the label and seal from the vent hole.
2. Proceed with steps 6 through 14 above.

*In the unlikely event that ink gets on your fingers, it can be easily removed by moistening a paper towel with a solution of laundry bleach diluted with an equal amount of water.
Be sure to wash hands thoroughly after using bleach solution.*

IF YOU HAVE ANY QUESTIONS OR ENCOUNTER ANY DIFFICULTY IN USING THIS PRODUCT, PLEASE CONTACT:

Repeat-O-Type Manufacturing Corporation • Wayne, New Jersey 07470-6892 USA
973/696-3330 • 800/288-3330 • Fax 973/694-7287 • Email: help@repeatotype.com