

Refilling Instructions

for Canon BC-01, BC-02, BX-2, BX-3 and Apple StyleWriter cartridges (see other side for special instructions when refilling Canon BX-3 cartridges)

1. Cover work area with several layers of newspaper or paper towels (spills are unlikely, but you should be prepared). Have facial tissues handy – if a spill occurs it should be blotted up with tissues.
2. Turn the printer off. Remove the print cartridge from the printer. Important: While handling the print cartridge **DO NOT** touch the print head and **DO NOT** rest the cartridge directly on the print head – this can cause damage to the print head or cause it to leak.
3. Locate fill hole plug on cartridge (see Illustration 1 & 1a). Using the tool provided, drill completely through the plug and into the cartridge. **COMPLETELY REMOVE** plug by pulling upward on the tool like a corkscrew (see illustration 1a).

**IF YOU HAVE THE BX-2, BX-3, DO NOT USE STEP 3.
SEE SEPERATE INSTRUCTION ON OTHER SIDE.**

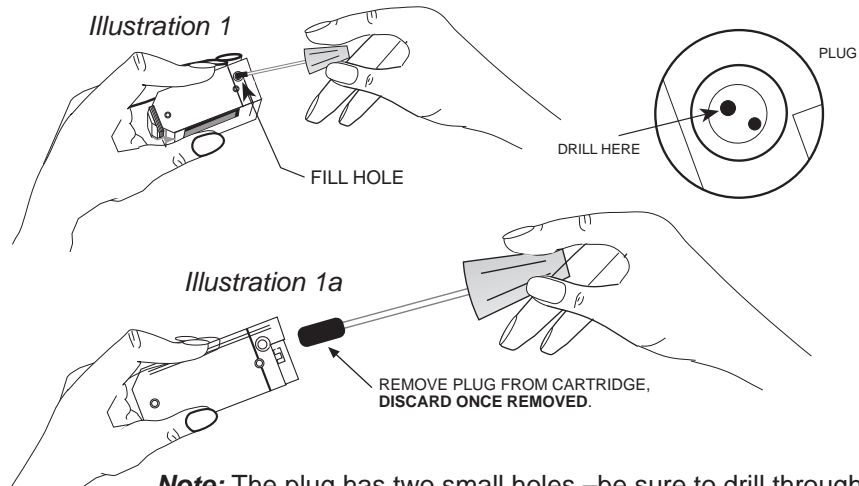

Note: The plug has two small holes –be sure to drill through the smaller outer hole to achieve grip necessary to remove plug. Refer to detailed drawing above. The plug can be discarded; it is no longer needed.

4. Take one refill bottle and remove scabbard from the filler tube. Holding the print cartridge in your hand, carefully insert the filler tube 1/2 to 3/4 of the way into the fill hole (Illustration 2).

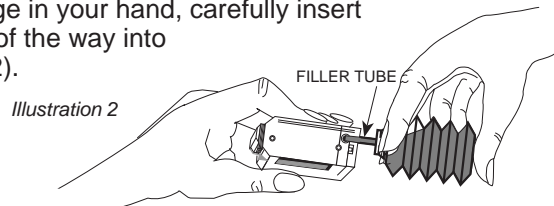

Note: These cartridges are foam filled and it is normal for there to be considerable resistance if the cartridge has been left empty for a period of time. If this is the case, dispense a small amount of ink and let stand for a while so that the foam regains its absorbency.

(continued on back)

5. Tilt the bottle until the filler tube is in the fully inverted position (Illustration 3). Gently squeeze the bottle until the entire refill bottle is emptied (Illustration 4) or until a droplet of ink appears at the fill hole (an indication that the cartridge is full).

NOTE: Do not release pressure from the bottle until after the filler tube has been completely withdrawn, otherwise the suction created by the release of pressure could cause ink to re-enter the bottle.

Illustration 3

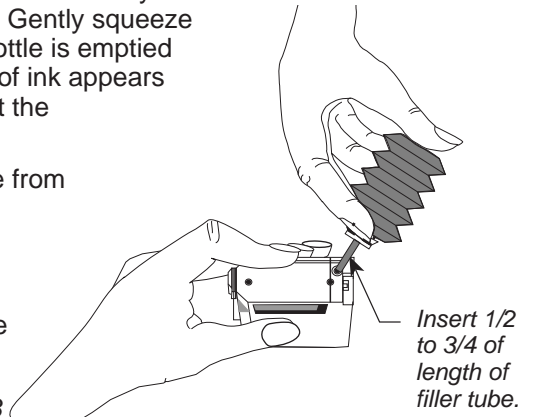

6. Bring the bottle back to the position shown in Illustration 2 (filler tube in horizontal position) and remove the refill bottle. If the refill bottle is not empty, recap it and save for future use. Blot up any residual ink around filler tube with a tissue. Allow a few minutes for the ink to rewet the print head.

Illustration 4

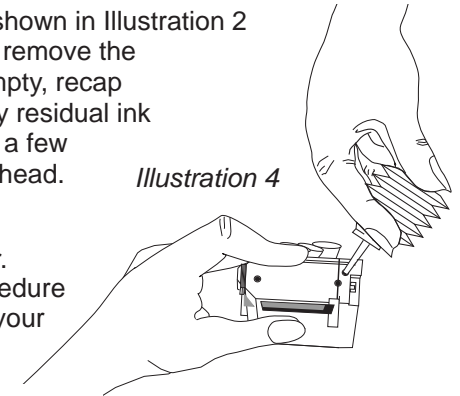

7. Reinstall the cartridge into the printer. Perform the print head cleaning procedure following the instructions outlined in your printer instruction booklet.

SPECIAL INSTRUCTIONS FOR REFILLING CANON BX-3 CARTRIDGES

Substitute the following for Step 3 of the instructions sheet:

Place the cartridge on your work surface with the clear plastic side facing up. Locate the steel ball which seals the refill hole of the cartridge. Using a ball point pen, or similar tool, push the steel ball into the cartridge.

Continue following Steps 4 and 5 of the instruction sheet.

Substitute the following for Step 6:

Withdraw the bottle from the fill hole and recap it if it is not empty. Blot up any residual ink from around the fill hole with a tissue. Make sure the surface around the fill hole is completely dry and then seal the fill hole with ordinary transparent tape. Be sure it is firmly sealed in place.

BC01R/INST/10.97

REPEAT-O-TYPE
MANUFACTURING CORPORATION
ESTABLISHED 1931

665 State Highway 23 • Wayne, NJ 07470-6892 • (973) 696-3330 • (800) 288-3330
Fax (973) 694-7287 • www.repeatotype.com • help@repeatotype.com